

Chimney Cowls

Downdraft Prevention Cowls

 **FlueSupplies**
UK CHIMNEY SPECIALISTS



Trade Catalogue



About Us

Flue Supplies is a family-run company with over 20 years direct experience of selling chimney products to the UK chimney trade and retail customers. All our products have been selected from quality manufacturers and are trusted by trade installers across the UK. We believe our products should give you both value for money as well as peace of mind.



Specifications

Product

We have a wide range of cowlings available to suit a variety of systems and requirements. Some are designed especially to fit to chimney pots, others to the chimney liners, some to flue systems. We also have a range of cowls designed to help eradicate downdrafts.

Our products are manufactured from high-quality aluminium alloy, stainless steel, M10 or galvanised steel. All of our products are designed to withstand normal operating temperatures in chimney flues of up to 250° C.

***The manufacturer may change the design of the products so dimensions may vary.**

Please use this chart to find the most suitable cowl for your flue system.

Cowl	Fuel Type				
	Coal	Wood	Gas	Oil	Smokeless Fuel
AD Cowl/ Vedette	✓	✓	✓	✓	
Colt Birdguard	✓	✓		✓	✓
Colt Top All Purpose	✓*	✓*	✓	✓	✓
Colt Top Gas	✓*	✓*	✓	✓	
Terracotta Colt Top 2 All Purpose	✓*	✓*	✓	✓	✓
Colt Top 2 Aluminium	✓*	✓*	✓	✓	
Colt Top 2 Stainless steel	✓*	✓*	✓	✓	✓
Decorative Birdguard	✓	✓		✓	✓
Eurocowl Stainless Steel	✓*	✓*	✓	✓	✓
H Cowl / OH Cowl	✓	✓	✓	✓	✓
High Top Gas			✓		✓
High Top Solid Fuel	✓	✓		✓	✓
High Top Stainless Steel	✓	✓		✓	✓
MAD Anti-Downdraft	✓	✓	✓	✓	✓
MAD High Top	✓	✓	✓	✓	✓
Mini Rotorvent	✓	✓	✓	✓	✓
Rain Cap	✓	✓	✓	✓	✓
Ultralite 2 Rotorvent	✓	✓	✓	✓	✓
Spark Arrester	✓	✓		✓	✓
Suspending Cowl	✓	✓	✓	✓	✓
Suspending Cowl Gas			✓	✓	
Turbolite Rotorvent	✓	✓	✓	✓	✓

* It is recommended that the birdmesh is removed for solid fuel burning.

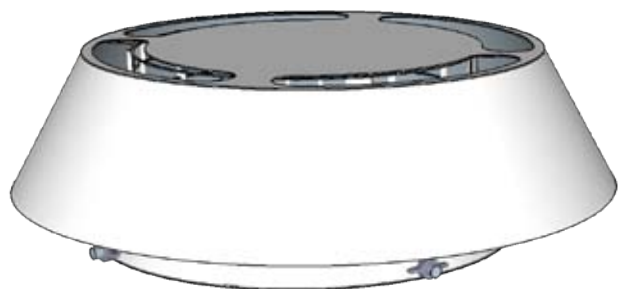

Colt Top

Creating a lift whichever way the wind is blowing, the circular shape of the Colt Top eliminates downdraft and diverts rain away from the inside of the pot.

There are two types available; Colt Top Gas (not for smokeless fuels), and the All Purpose (for all fuels) in terracotta or in a buff finish. All come fully assembled with bolts for fixing. Fits diameters from 125mm to 250mm.

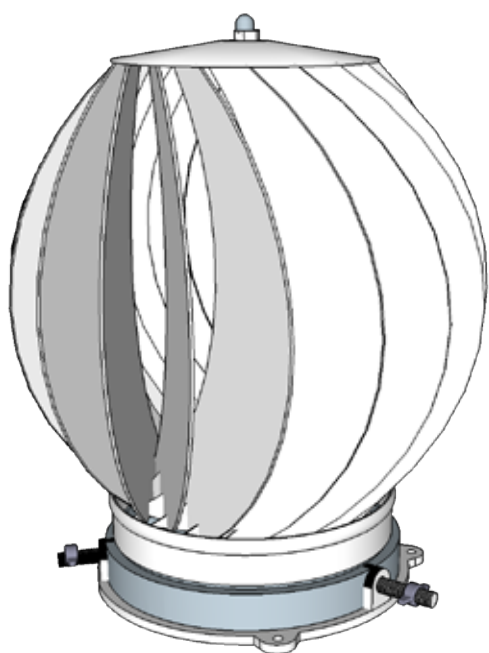

Turbolite Rotorvent / Mini-Rotorvent / Ultralite 2 Black

Made from stainless steel with a die cast aluminium base, the Rotorvent turns with the wind creating a draw of fumes up the chimney system. It comes complete with two fixing methods, bolt and strap and has been tested with temperatures from minus 20°C to 250°C.

There are 3 types available:

The Turbolite Rotorvent (from 80mm - 250mm) and the Mini Rotorvent which is designed to fit smaller diameter flues (from 80mm to 180mm).

The Mini Rotorvent comes with bolt fixings only. A strap fixing kit is available separately.

The Rotorvent Ultralite 2 Black comes with bolt fixings only. A strap fixing kit is available separately.

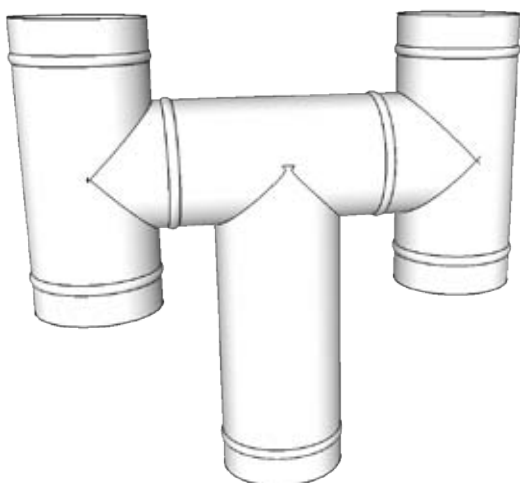

H Cowl /

OH Cowl

A static cowl, designed to prevent downdraft, works by creating a wind flow as wind passes above the cowl to exhaust the fumes and smoke out of the lower exits.

These range from 125mm - 350mm in diameter.

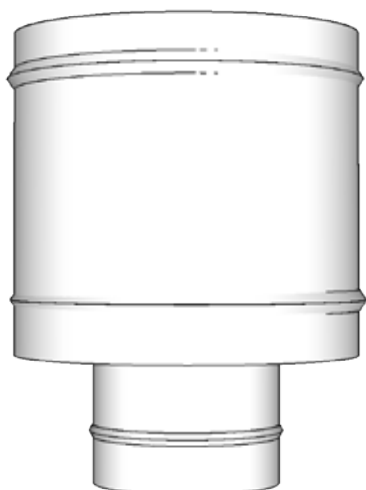

AD Cowl /

Vedette

This static cowl fits to the end of the flue system and helps reduce downdraft in all weather conditions. It works in any wind direction and is available in 100mm- 300mm flue diameters.

Suitable for use with oil, gas and solid fuel appliances.

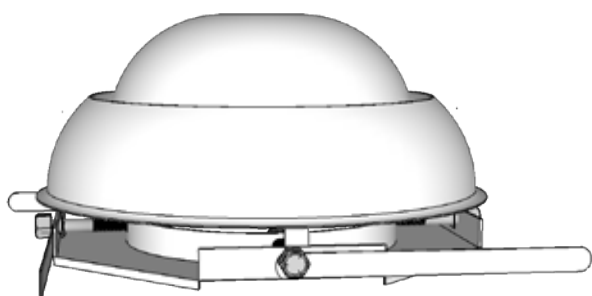

Eurocowl

Designed to cure smokey fireplaces, it creates a positive airflow whatever the wind direction. It also protects against rain and animal or bird entry.

Made of Stainless Steel and fits flue sizes 125mm-250mm. Strap fixing.

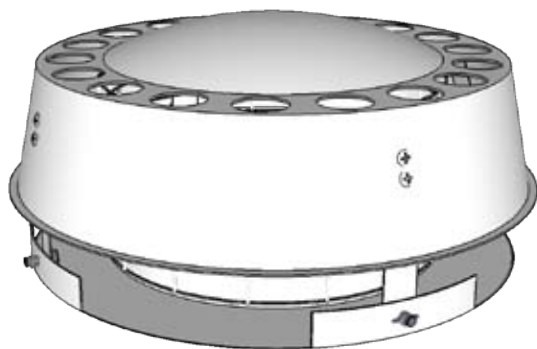

MAD Cowl

Anti-Down Draft

Similar to the Colt Top, this also helps eliminate downdraft whilst protecting against unwanted bird and animal entry.

Terracotta in finish, it comes fully assembled with bolt or strap fixings. Fits diameters from 125-250mm.

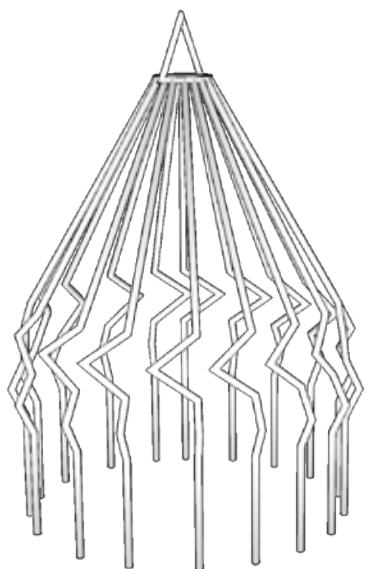

Bird Guard

Decorative

Made of M10 steel with a terracotta finish, it is designed to stop birds from getting down the chimney. The legs of the cowl push into the pot to secure.

Fits pots from 150mm - 250mm diameters.

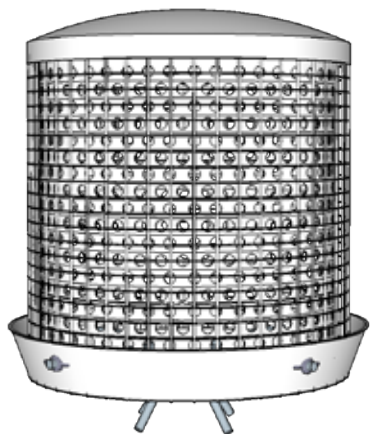

Spark Arrester

Especially designed for use on shingled and thatched properties, this cowl has two different meshes which allow any lit debris to self extinguish.

It is made of steel and aluminium and has a terracotta finish. Fits pots from 150mm - 250mm.

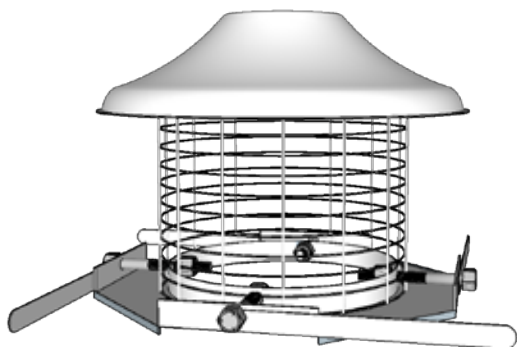

Eurocowl Hightop

This cowl protects against unwanted bird or animal entry and leaves and other debris entering the flue system.

It comes with fittings for both strap or bolt fixings and provides easy access into the flue system for cleaning. Will fit pots from 125mm to 250mm.

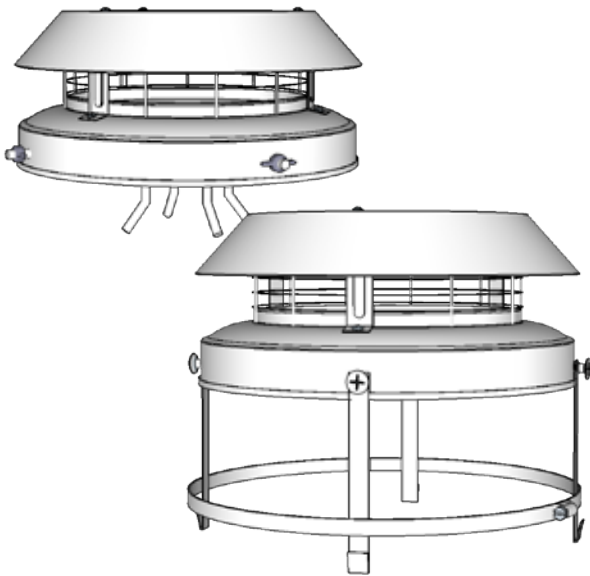

Colt Top 2

(Available with bolt and strap fixing)

There are three versions of this cowl; Colt Top 2 (aluminium), Colt Top 2 All Purpose (terracotta finish), Colt Top 2 Stainless Steel.

All come ready assembled to fit onto a chimney pot and fit (externally) flue sizes from 125mm to 250mm. It is available with both bolt or strap fixings.



Hightop Birdguard

Available in three variations;

- *Solid Fuel (terracotta or buff finish)
- *Gas (terracotta finish only)
- *Stainless Steel (terracotta finish, not for gas use).

This cowl is designed to prevent unwanted bird and animal entry and helps reduce the potential of clogging from debris.

It is strap fixing and fits flues from 125mm-250mm.

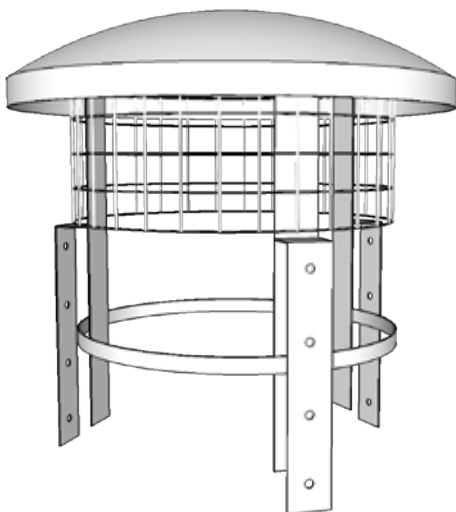

Colt Birdguard

This cowl is made from galvanised steel and has mesh to guard against bird entry. It also helps reduce rain ingress into the flue.

The feet slide over the edge of the chimney pot and are tightened with the jubilee clip provided. It has a terracotta finish and can fit pots from 100mm - 200mm.

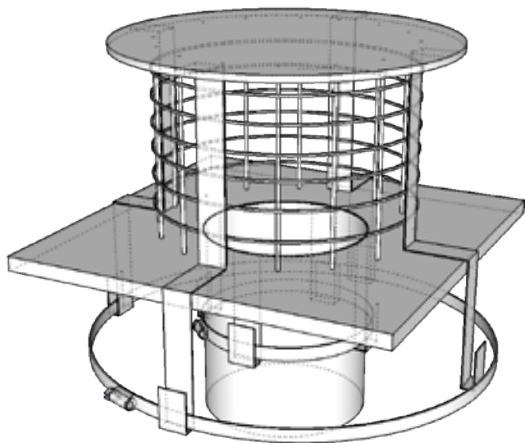

Suspending Cowl

Square Based

These are designed to suspend liners where a square chimney pot is in situ.

Also available in a stainless steel or terracotta finish. These are available in 5", 6" and 7" flue diameters.

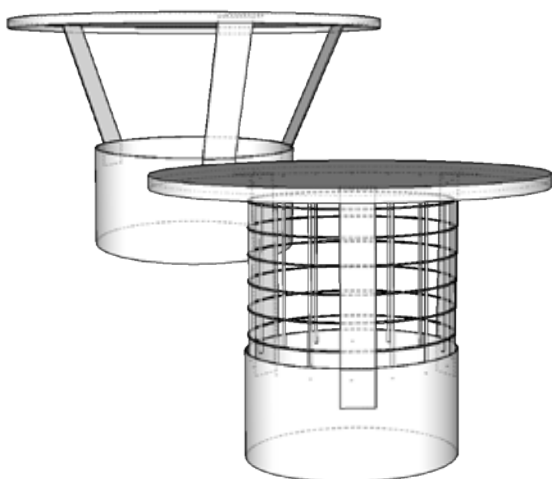

Rain Cap

Designed to fit directly onto the end of a liner where no chimney pot is in place. The liner should be suspended with a top clamp, plate and insert before this cowl is installed.

Available with and without mesh to protect against unwanted bird entry. Mesh is recommended for gas and oil use especially.

These range in diameters from 100mm to 250mm.

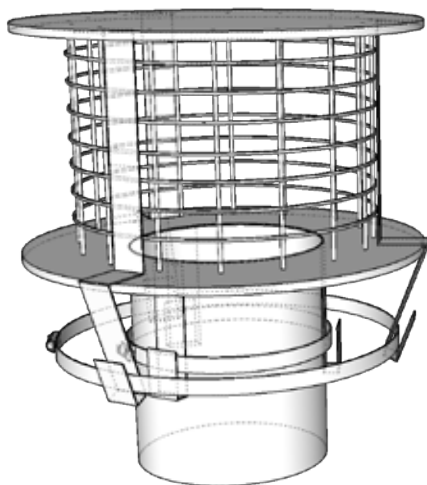

Suspending Cowl

Designed to fit directly to the chimney liner, the spigot in the centre goes inside the end of the liner and tightens with the strap provided. The rain cap and mesh section then sits on top of the chimney pot and can be secured using the larger clip.

Available in a stainless steel or terracotta finish, in 125mm - 200mm diameters.

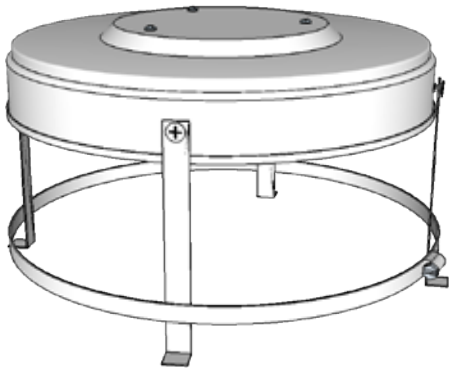

Chimney Capper /

Top Lid

This is used to close off any unused chimneys whilst still allowing ventilation. It will stop rain ingress whilst also preventing heat loss. Simply tighten strap on to the chimney pot to secure. Fits chimney pots from 125mm - 250mm external.

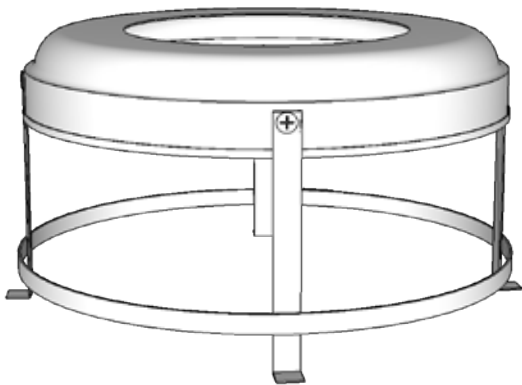

Pot Adaptor

Oversized

This can fit chimney pots with an outside diameter of up to 390mm and will adapt the size of the pot to use with the Colt Top, Hightop, Top Lid or Rotorvent range of cowls (not for use with the Mini Rotorvent).

Available with and without a flanged top depending on the cowl used. Strap fixing.

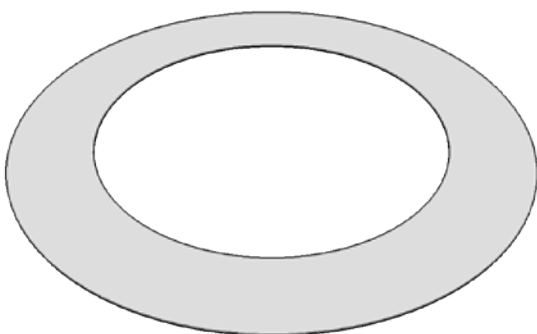

Reduction Plate

Different versions available for use with the Colt Top, Spark Arrester and with the large Rotorvent (with gas use only). This will reduce the flue dimension between 125-175mm and allow the cowl to be installed.



ISO 9001
FS 576960